

**Purse shelves should be joined by using the provided countertop draw bolts.**

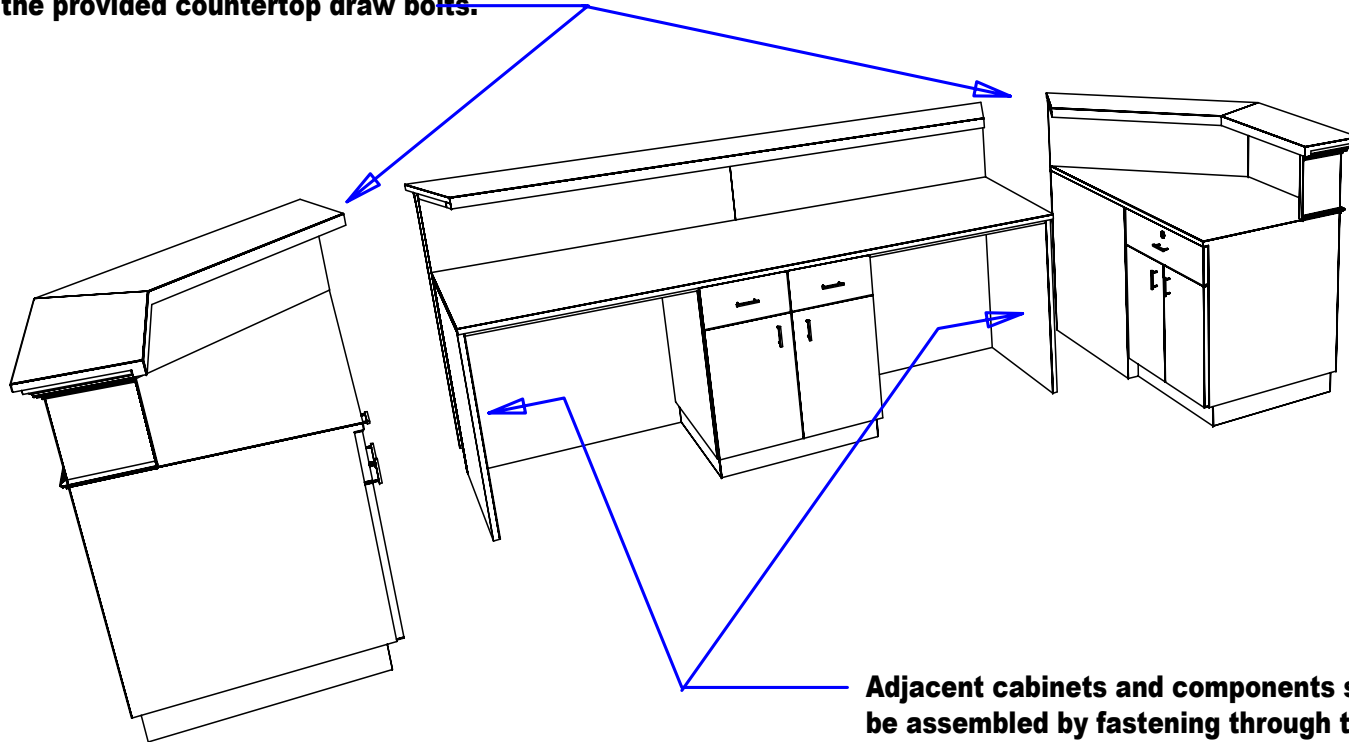

**Adjacent cabinets and components should be assembled by fastening through the interior panels with the screws or bolts provided. Tighten securely.**

**Quantity -**

**Finish Schedule**

Face Color -  
 Top Color -  
 Toe Color -  
 Pulls -  
 Interior -  
 Other (Specify) -

**General Notes:**

- 1. All counter tops are to be made removable wherever possible.**
- 2. Items must be broken into manageable sections For Shipping. Mark For Ease Of Reassembly.**
- 3. Install Shipping Cleats Wherever Possible To Prevent Shipping Damage.**
- 4. Purchased items Must Be Trial Fit Before Shipping.**



**Collins Manufacturing**  
 809 E 20th Street  
 Cookeville TN 38501

Title: **Salon Equipment USA**

Size: # **48040C-4**

Drawn By: **Steve**

Date: **08/26/03**

Sheet #: **7**